

Ronix[®]

Premium Quality

12 INCH MECHANICAL MEASURING WHEEL RH-9857



SPECIFICATIONS

Model	RH-9857
Handle Material	ABS
Wheel Material	ABS+PVC
Section	3 sections
Full Length	100cm
Folded Length	35cm
Wheel Diameter	318mm
Weight	1.2Kg
Supplied in	Cloth Bag

PART LIST

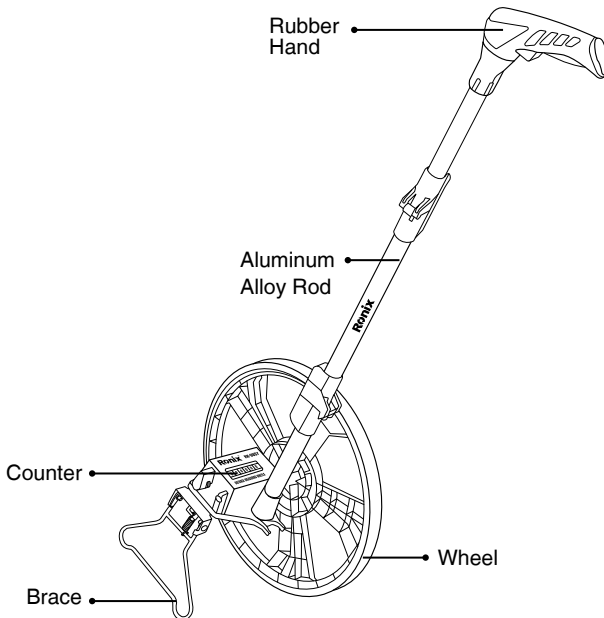

■ **PRODUCT FEATURES:**

The gear driven counter is placed in a sturdy plastic box.

5digit counter, mechanical gear type drive, with manual reset device.

Heavy metal folding handle and rubber handle, ergonomic.

The engineering plastic measuring wheel, the outsourcing elastic rubber face is strong and durable, the strength is high.

The spring folding bracket is stable and reliable.

■ **METHOD OF USE:**

The Fold pattern is shown in pic 1. Extend the distance wheel lever and lock it by pressing the button (see pic 2) then Brace yourself (see pic 3) and return the counter to zero (see pic 4). Light range the wheel is placed at the starting point of the measured length, and the arrow is pointed at the starting point of the measurement. Artificial walk to the measuring point. Read the measured value.

⚠ NOTE:

if you measure a straight-line distance, Try to keep a straightline between starting point and your final point.

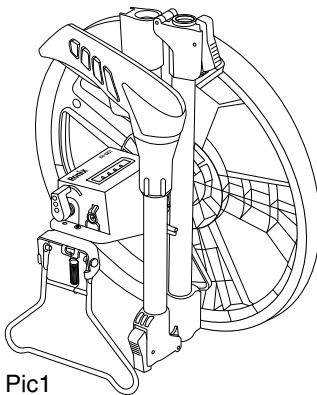

Pic1

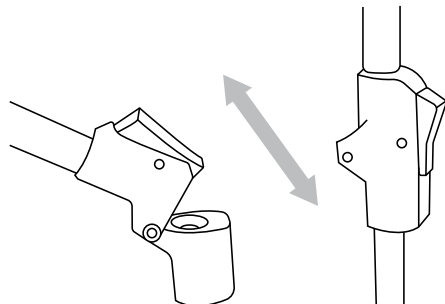

Pic 2

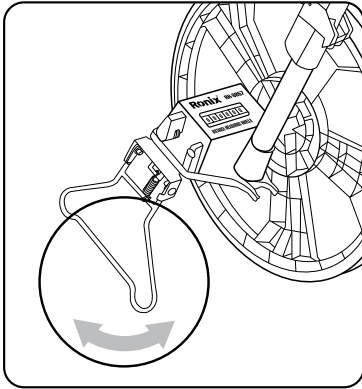

Pic 3

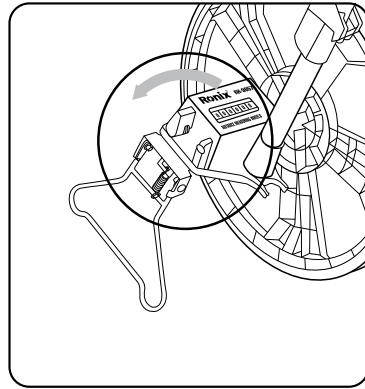

Pic 4

! WARNING:

Be sure to return the counter to zero before measuring. After you see it the needle is perpendicular to the measured ground, and the counter displays 0000.0 m to level the wheel,

If a line is measured, the accuracy of the measurement is guaranteed, Don't measure the uneven surface, or it will reduce the accuracy of the Measurement.

- Don't measure in the rain for long.
- Don't measure in a high temperature environment. Don't store the instrument at high temperature.

Do not use this instrument as a child's toy to avoid unwanted damage.



www.ronixtools.com