

Electric Router

1850W

7112

- Professional heavy-duty 1850W motor ensures outstanding functionality to handle a wide range of woodworking applications
- High-speed efficient machine delivers up to 22,000 RPM for the fastest and cleanest cuts even on the tough hardwoods
- Variable speed setting from 5,000 to 22,000 RPM
- Precision cutting depth adjustment mechanism ensures quick and accurate height adjustments
- Three-level stop to preselect up to 3 different routing depths in order to perform various applications
- Three kinds of collet chuck capacity (6mm,8mm,12mm) enables different operations
- High durability and accuracy obtained by using aluminum for body housing
- Soft start function for smooth start and safe operation
- Aluminum die cast base plate plus durable steel springs ensures easy sliding and improves performance of depth adjustment
- Rubberized soft grip handles provides superior comfort, balance, and control even during extended jobs
- Replaceable, non-marring plastic base plate for protection of plunge base and smooth sliding on work surface
- Simple and efficient base lock system
- Suitable for a broad range of applications including precise bit plunging, edge forming, slot cutting, laminate trimming,...
- Spindle lock for easy and safe router bit change
- Dust plastic shield for controlling chips and dust wood ejection

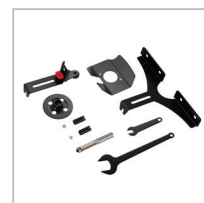

Model	7112
Power	1850W
Voltage	220-240V
Frequency	50-60Hz
Collet Size	6mm-8mm-12mm
No-load RPM	5,000-22,000 RPM
Weight	6kg
Supplied In	Ronix Color box
Includes	2 Spanners, 2 Collet sleeve, Flush trim router bit, Dust plastic sheild, Trimmer guide, Straight guide, Template guide, Guide holder