

Ronix[®]

Premium Quality

GASOLINE GENERATOR 800W RH-4702



SPECIFICATIONS

Model	RH-4702	
Engine	Model	LBIE45F
	Displacement	63cc
	Rated Power	2.5 HP
	Ignition System	CDI
	Start Model	Manual
	Fuel Tank Capacity	4L
	Frequency	50Hz
Generator	Rated Voltage	220V
	Rated Amperage	2.8A
	Rated Power	650W
	Max Power	800W
	Weight	16Kg

PARTS LIST

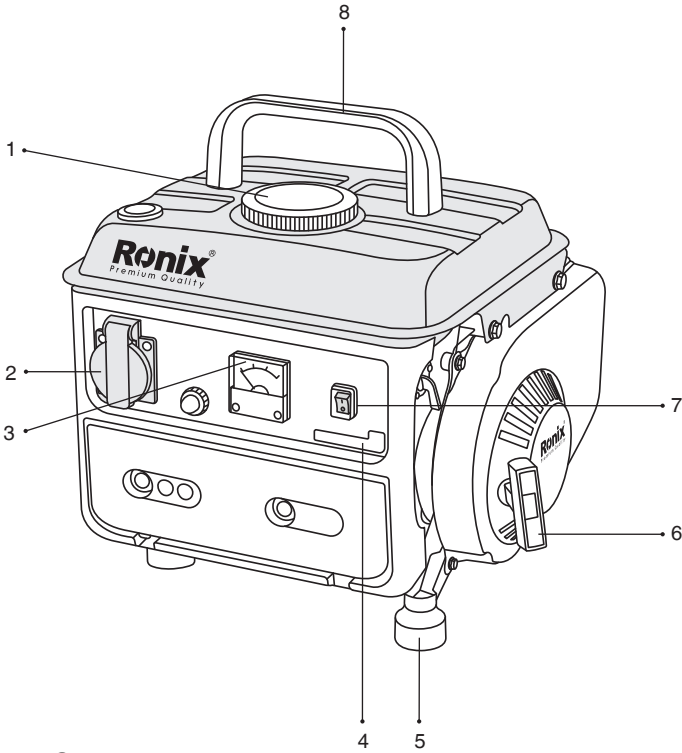

- 1- Fuel Tank Cap
- 2- Socket
- 3- Voltmeter
- 4- Choke Lever
- 5- Base
- 6- Manual Start
- 7- Engine Switch
- 8- Handle

DEAR CUSTOMERS:

Welcome to use our products. Please read carefully the operation instructions before operation, so as to avoid unnecessary troubles to you.

■ SAFETY KNOWLEDGE

- To prevent exhaust poisoning, it is forbidden to operate the machine indoor or in places badly ventilated.
- To prevent exhaust poisoning and fire accident, the exhaust pipe should not face buildings or equipments when exhausting.
- To prevent fire accident, engine must be shut down before oiling.
- To prevent fire accident, overflowed fuel oil must be wiped clean.
- To prevent fire accident, the type of chosen fuel oil and stipulated oiling must be attended.
- To prevent fire accident, it is not allowed to operate in places with tinder.
- To prevent electric shock, it is not allowed to operate in raining or snowing environment.
- To prevent electric shock, it is not allowed to touch the wiring socket with wet hand.
- To prevent electric shock and fire accident, it not allowed to be connected with power supply line of citizens.

■ PREPARATION BEFORE OPERATION

- Gas blended with engine oil should be adopted, otherwise, the engine will occur the problem of tank-dragging. The proportion between gas and engine oil is 50:1

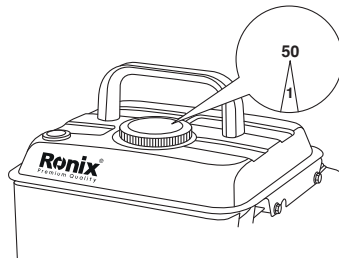

- To prevent electric shock, it should be earthed when operating the machine.
- Volume of the fuel tank is 4.2 liters.
- Do not fill the oil in excess of top of oil strainer.

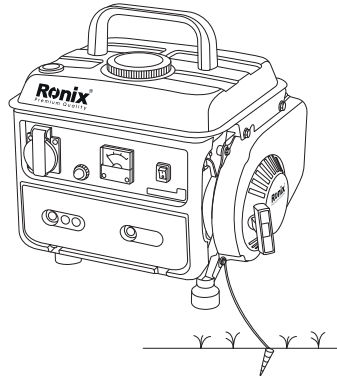

- How to prepare blending gas
- As the figure, measure the volume of engine oil with the fuel tank cap.

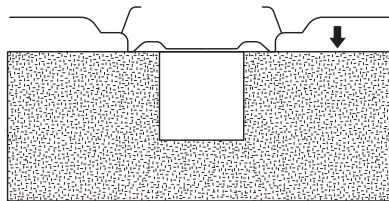

- Pour gas and engine oil into one vessel in proportion of 50:1 (One tank gas plus engine oil of one fuel tank cap)
- Pour into fuel tank after shaking up.

■ STARING OF ENGINE

Before starting the engine, remember not to connect it with electric devices.

0.02L	
0.04L	
0.06L	
0.08L	

- Before starting the engine, shake the fuel tank.

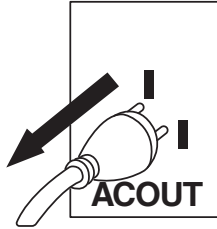

- Move the controlling bar of fuel switch to the position ON.

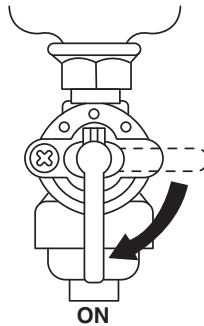

- Move the throttle handle to the starting position of (1).

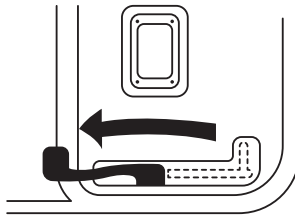

- Set the engine switch at the position of ON.

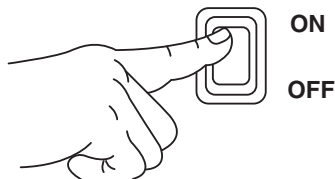

- Pull the recoiling starter slowly till it is closed tightly, and then pull it sharply.

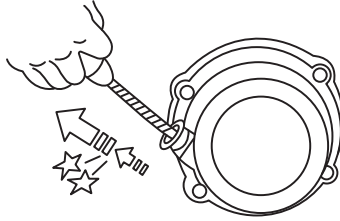

- After starting of engine, move the throttle handle slowly back to the position Run.

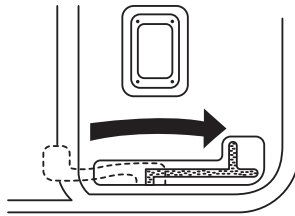

■ SHUTDOWN OF ENGINE

1. Before stopping, the electric devices must be shut off.

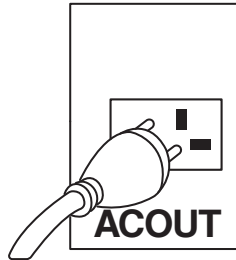

- Turn the starting switch to the position of OFF.

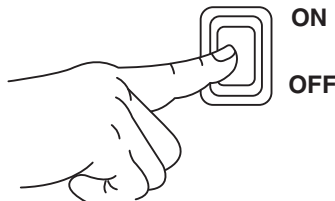

- Move the controlling bar of fuel switch to the position OFF.

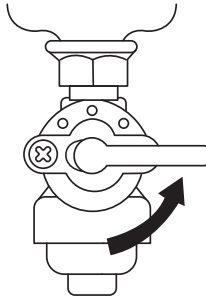

■ WIRING

- Wind the electric wire on handle grip for 2-3 circles.
- Start the engine.
- Safety devices
- If the protector of AC alternating current is closed, the output load should be decreased, and press the restoration button to reset the protector.

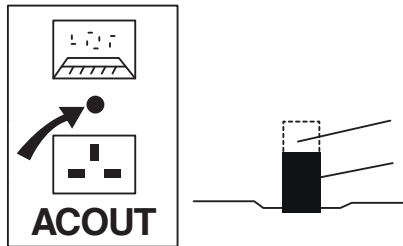

1- "RESET"

2- "OFF"

- Insert the plug into socket of AC alternating current.

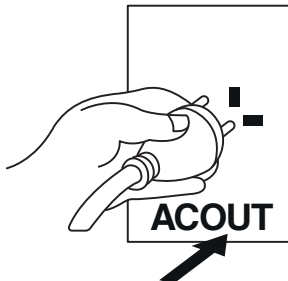

■ PERIODICAL MAINTENANCE

- Ignition plug (Cycle: every 50 hours or every month)
- Take down the ignition plug.

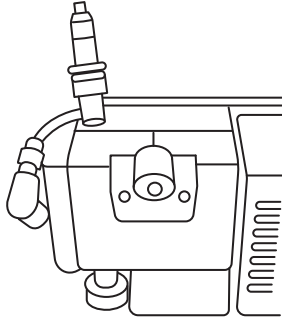

- Clear away the accumulated charcoal.

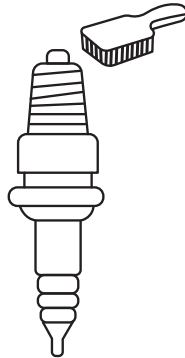

- Check the condition of fading in color. Standard: Olive brown
- Check the gap of ignition plug Standard: 0.7-0.8mm

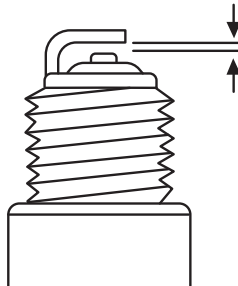

■ AIR CLEANER (CYCLE: EVERY 150 HOURS OR EVERY MONTH)

- Take down the air cleaner.
- Clean it by washing in dissolvent.
- Add some engine oil (SEA20)
- Squeeze out engine oil.

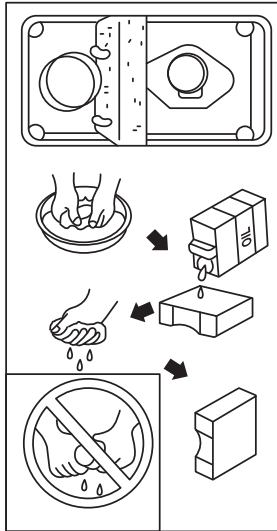

⚠ WARNING!

Do not start the engine without air cleaner.

OIL STRAINER (CYCLE: EVERY 150 HOURS AND EVERY 3 MONTHS)

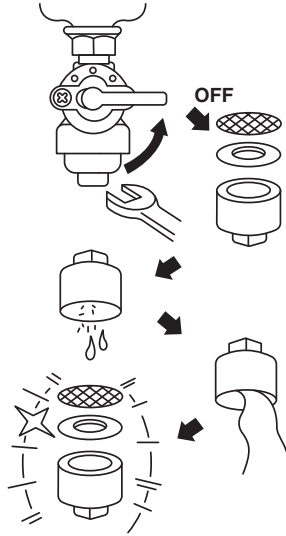

- Stop the engine
- Shift the fuel switch to OFF.
- Clean it by washing in dissolvent.

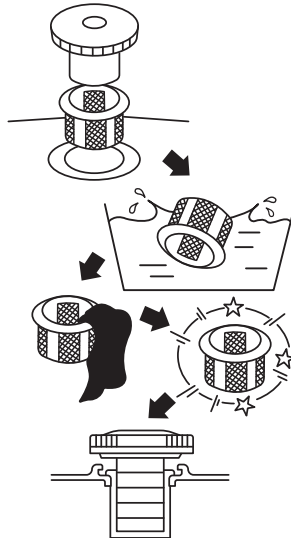

- Clean it by washing in dissolvent.
- Wipe it clean.
- Insert it into fuel tank



APPLICATION RANGE

Electric Devices		Maximum Load	Power Factor
AC		800 W	1
		600 W	0.7-0.8
		700 W	0.7-0.95

TROUBLESHOOTING

■ WHEN ENGINE IS NOT ABLE TO START

- Check fuel oil.
- Check the engine switch.
- Check the ignition plug.
- If the engine is still not able to start, check the following conditions:
 - Check if the fuel switch is blocked.
 - Check if the air cleaner is blocked.
 - Or query on dealers.

Ronix[®]
Premium Quality