

# Ronix<sup>®</sup>

Premium Quality

## VACUUM CLEANER

### 8640

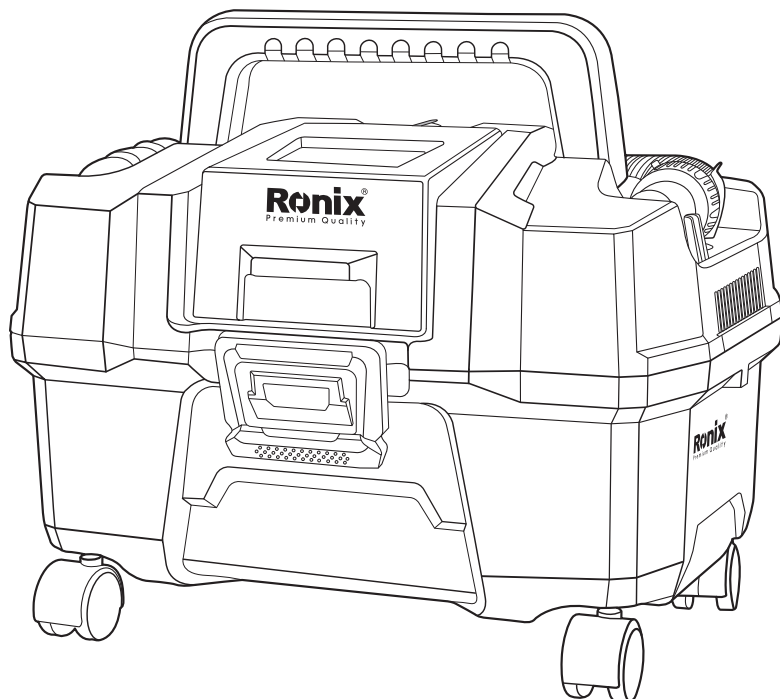

[www.ronixtools.com](http://www.ronixtools.com)

## TECHNICAL SPECIFICATIONS

Model	8640
Voltage	20V DC
Motor Power	150W
Vacuum Pressure	>10KPA
Airflow rate	20L/S
Weight	4.27Kg
Supplied in	Ronix color box
Includes	plastic hose, Washable HEPA Filter, Sponge filter, Triangle brush, crevice nozzle, 1 pc Battery 2Ah, 1 pc Charger 2A

## PART LIST

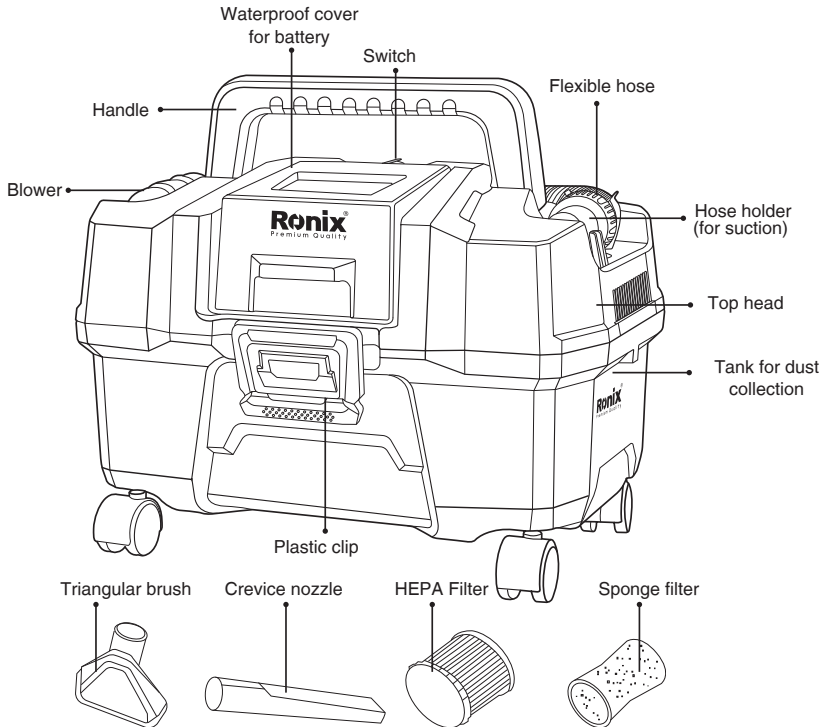

**⚠ ATTENTION!**

Before operating, please read and understand this manual carefully, as Failure to follow all instructions listed below, may result in electric shock, fire and/or serious personal injury.

**⚠ ATTENTION!**

Only the Ronix batteries cartridges and chargers are recommended for this item.

Usage of any other batteries cartridges and chargers may cause breakdown and injury.

**■ SAFETY INSTRUCTIONS**

- Before operating this appliance, please go through the details of this item, including the battery, charger and accessories. Make sure everything in the following accessory list ( PAGE 3 ) is contained and unbroken.
- This appliance is not intended for use by persons (including children) with reduced physical, sensory or mental capabilities or lack of experience and knowledge, unless they have been given supervision or instruction concerning use of the appliance by a person responsible for their safety.
- Keep all the items included away from children under 18 years old.
- Do not handle this appliance with wet hands, in case of any electrical shock.
- Make sure the battery slot, battery cartridge, and charger are always dry, in case of any electrical shock.
- Do not charge the battery cartridge in a damp or wet location. Do not use, store, or charge it in locations where the temperature is less than 50°F or more than 100°F. Do not store it outside or in vehicles.
- Remove battery when the vacuum is not in use and before servicing.
- When battery pack is not in use, keep it away from other metal objects like: paper clips, coins, keys, nails, screws, or other small metal objects that can make a connection from one terminal to another. Shorting the

battery terminals together may cause sparks, burns, or a fire.

- Do not use a battery cartridge which is damaged or modified.
- Do not overturn this appliance, as dust and liquid may enter the inner structure through the air inlet.
- Any broken parts should be modified or repaired by technicians appointed by your local stores for this brand.
- Keep hair, loose clothing, fingers, and all parts of body away from openings and moving parts.
- Do not use the appliance to pick up hot water / liquids, flammable items or combustible liquids (i.e. petrol, hot ashes cigarettes, matches, explosive materials or anything burning) or use in areas where such substances and items may be present.
- The appliance doesn't support working while charging.
- Pay attention to the maximum distance which the flexible hose can reach. Keep proper footing and balance at all times.
- Never vacuum dry dust and trash without the HEPA filter fitted.
- Remember to clean the tank, the filter, the flexible hose and accessories after usage.
- If the appliance doesn't work, or if you are facing any technical problems, please contact Ronix service center.

## **OPERATION**

### **CONNECTION OF FLEXIBLE HOSE AND ACCESSORIES**

**■BEFORE OPERATION, THS APPLIANCE, THE FLEXIBLE HOSE AND ACCESSORIES SHOULD ALWAYS BE WELL CONNECTED.**

## ■ FOR SUCTION

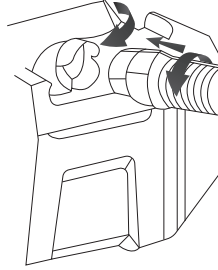

- Pull the hose holder to the right direction.
- Plug the connector of the hose into the holder.
- Turn the connector clockwise for locking.

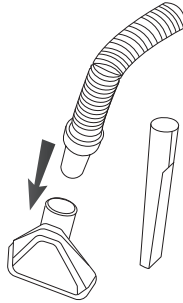

- Connect the triangular brush / crevice nozzle with the flexible hose for usage in different cases.

## ■ BLOWER

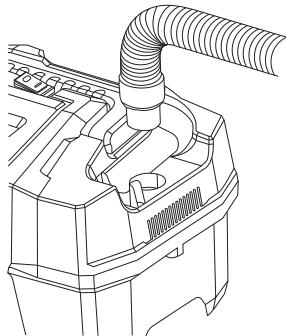

- Plug the connector of the hose into the blower.
- Turn the connector clockwise for locking.

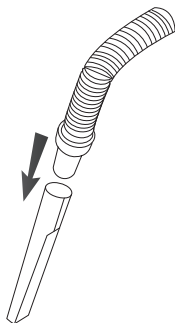

- Connect the crevice nozzle with the flexible hose for stronger airflow.

## ■POWER ON

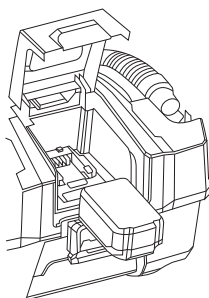

- Press the button on the battery cartridge, and plug it into the battery slot.
- Keep the battery cover closed.

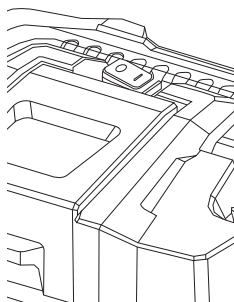

- Turn the switch to ' I ' to start the appliance.
- Turn the switch to ' 0 ' to stop the appliance.
- The light of the switch is on with normal power supply.

## ■ DRY VACUUMING

Please only vacuum debris in proper size to fit through the flexible hose and accessories.

- Make sure that the flexible hose and accessories are connected, and the HEPA filter is installed properly, in case of leakage.

Do not vacuum the following:

- Flammable liquid (kerosene, gasoline, solvents such as benzene, thinner, etc.)
- Hot substances that are burning or smoking (cigarettes, matches, incense sticks, candles, hot ashes), sparks and metal dust generated by cutting or grinding metal, etc.
- Flammable material (toner, paint, spray, etc.)
- Foam like carpet cleaning agent, etc.  
(they may cause explosion or fire)
- Explosive or pyrophoric substances (nitroglycerin, aluminum, magnesium, titanium, zinc, red phosphorus, yellow phosphorus, celluloid, etc. and their dust, gas or steam)
- Sharp objects (glass, cutlery, wood splinter, metal, stone, nail, razor, push pin, etc.)
- powder (metal or carbon powder)
- Dehumidifier
- Large amount of powder (flour, fire extinguisher powder, etc.)
- Substances that cause toxic symptoms
- Aggressive chemicals (acid, bleach, etc.)
- Liquid or damp garbage, including vomit and excreta
- Asbestos
- Pesticides
- When vacuuming fine debris in a case with low humidity, there might be static shock on the surface of the appliance. Please,

- Wear insulating gloves, or spray water mist around to increase the humidity.

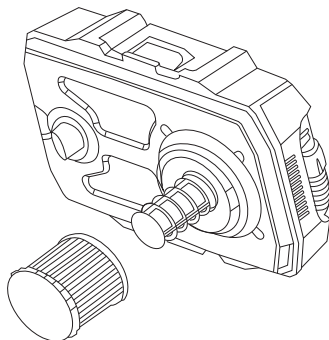

- Push the HEPA filter onto the filter seat.
- Make sure the joints on the filter are directed to the slots on the filter seat.
- Turn the HEPA filter clockwise for locking.

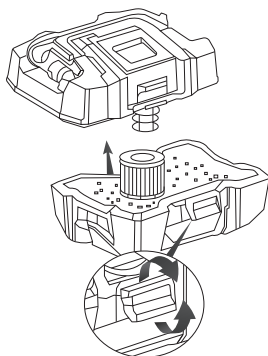

- Fit the head of the appliance on the tank properly.
- Lock 2 clips.

## ■ WET VACUUMING

Be aware that the cover for battery cartridge should always be closed, otherwise any liquid permeating the battery cartridge may cause danger.



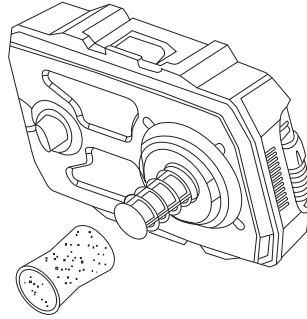

- Cover the sponge filter around the volve.

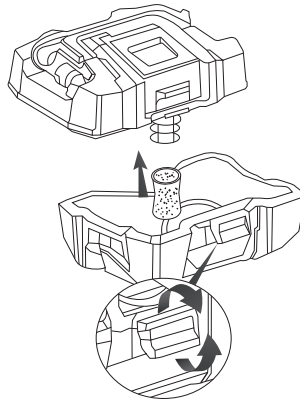

- Fit the head of the appliance on the tank properly.
- Lock 2 clips.

## **MAINTANENCE**

- Make sure the appliance is switched off and the battery cartridge is removed when the appliance is not under operation.
- Keep the appliance and accessories dry when they are not under operation.

## ■CLEANING OF TANK

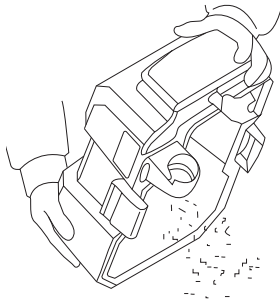

- Empty the tank by turn it over, and shake it.
- Wipe the tank inside with a duster cloth / paper.

## CLEANING OF FILTERS

### ■SPONGE FILTER

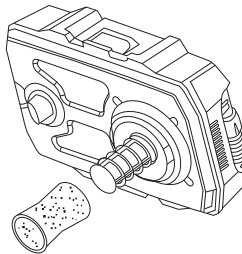

- Pull the sponge filter off from the water volve

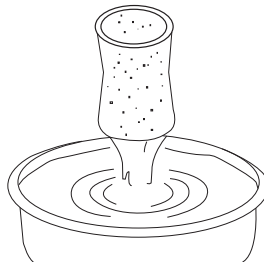

- Wash the sponge filter with water under 40°C gently.
- Dry it for 24 hours.

## ■ HEPA FILTER

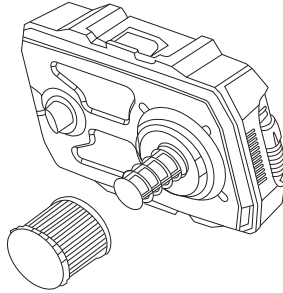

- Turn the HEPA filter anticlockwise for unlocking it from the filter seat.
- Pull it off from the water volve.

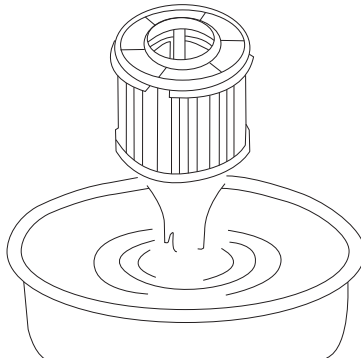

- Clean the surface of the HEPA filter with a brush.
- Wash it with water under 40 °C gently.
- Dry it for 24 hours.



**Ronix**<sup>®</sup>  
Premium Quality