

# Ronix<sup>®</sup>

Premium Quality

## GASOLINE LAWN MOWER 4451

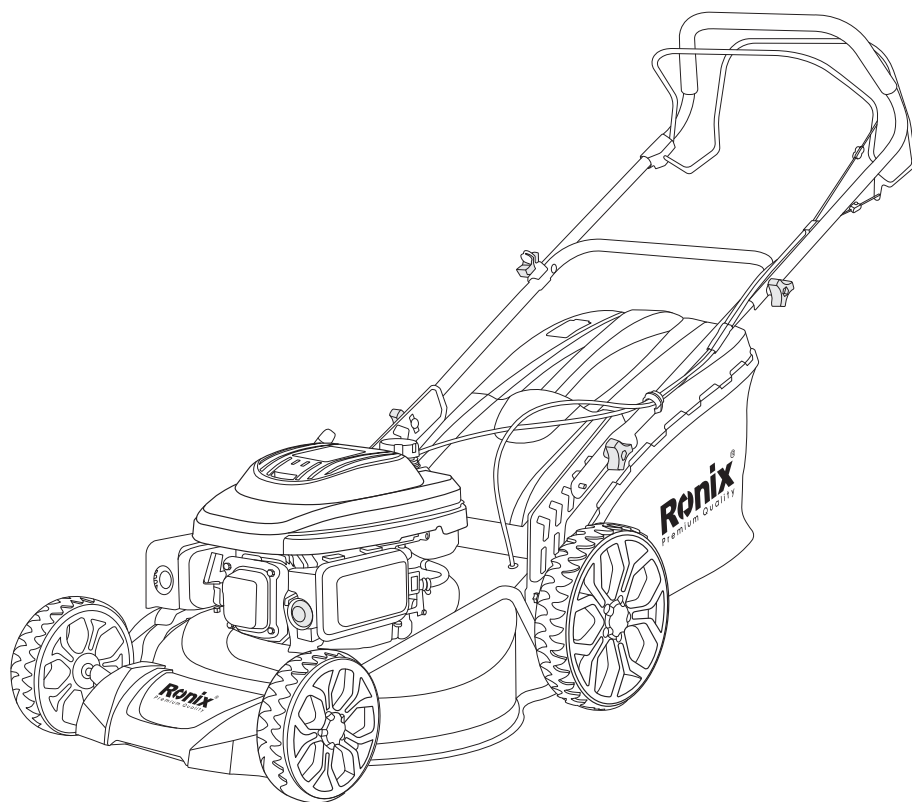

[www.ronixtools.com](http://www.ronixtools.com)



## TECHNICAL SPECIFICATION

Model	<b>4451</b>
Engine Power	6.5HP
Engine Type	Single Cylinder, Four Stoke, Air Cooled
Fuel Tank Capacity	1.3L
Oil Tank Capacity	600ml
Carburetor Type	Float Carburetor
Fuel Consumption Rate	0.95 l/h
Displacement	196cc
Maximum No-Load Speed	2900RPM
Ignition System	Inductance Type
Starting System	Recoil Start
Engine Noise Level (Lpa)	98Db
Body Dimension	1660 × 1040 × 560mm
Body Material	Steel
Handle Dimension	1120 × 480mm
Handle Material	Q235(steel)
Handel Height Adjustment	910-1180mm
Handel Tilt Adjustment	23-40°Degree
Cutting width	510mm
Grass Catcher Capacity	70L
Grass Catcher Material	Fabric With Plastic Cover
Wheels Dimension	203/280mm
Cutting Height Adjustment	6 Positions (30,40,50,60,70,80mm )
Blade Type	Straight Blade
Blade Material	40Mn
Total Weight	35Kg
Net Weight	32.5Kg
Includes	4pcs Knob 1pc Clip 4pc Bolt 1pc Hook 1pc Spark Plug Wrench 1pc Spark Plug Sleeve

## PART LIST

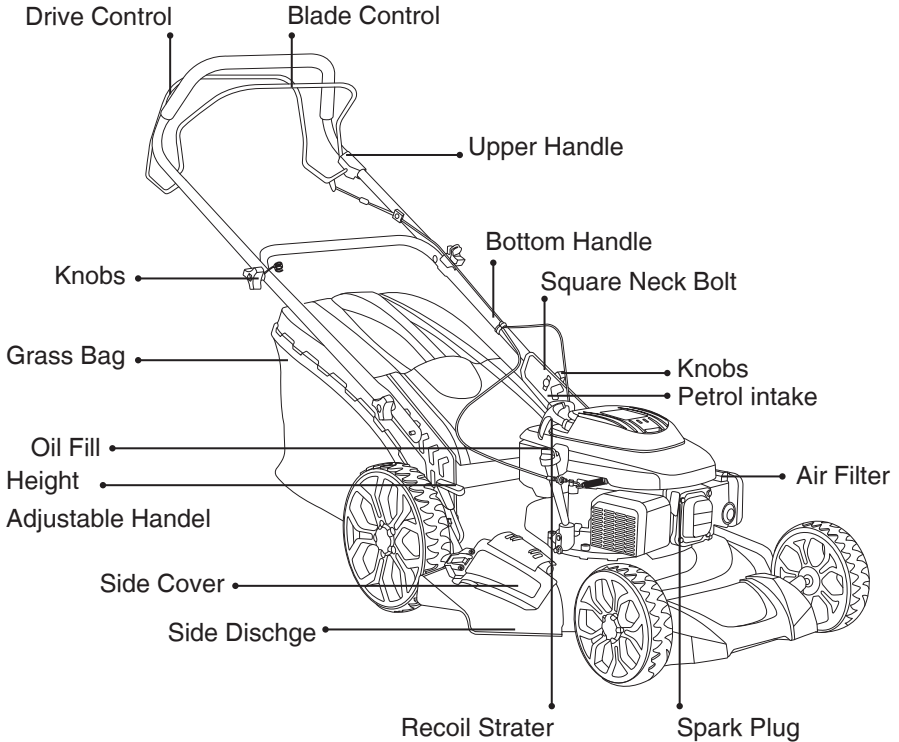

Please read these instructions carefully and make sure you understand them before using this machine.

## SAFETY RULES

### **⚠ IMPORTANT!**

This cutting machine is capable of amputating hands and feet and throwing objects. Failure to observe the following safety instructions could result in serious injury or death.

### **■ TRAINING**

- Read the instructions carefully. Be familiar with the controls and the

proper use of the equipment.

- Never allow children or people unfamiliar with the instructions to use the lawnmower. Never mow while people, especially children, or pets are nearby.
- Keep in mind that the operator or user is responsible for accidents or hazards occurring to other people or their property.

## **PREPARATION**

- While mowing, always wear substantial footwear and long trousers. Do not operate the equipment when barefoot or wearing open sandals.
- Thoroughly inspect the area where the equipment is to be used and remove all objects which may be thrown by the machine.

### **WARNING!**

- Petrol is highly flammable.
- Store fuel in containers specifically designed for this purpose. Refuel outdoors only and do not smoke while refueling. Add fuel before starting the engine. Never remove the cap of the fuel tank or add petrol while the engine is running.
- Add fuel only when the engine is cold.
- If petrol is spilled, do not attempt to start the engine but move the machine away from the area of spillage and avoid creating any source of ignition until petrol vapors have dissipated.
- Replace all fuel tanks and container caps securely.
- Before using, always visually inspect to see that the blades, blade bolts and cutter assembly are not worn or damaged. Replace worn or damaged blades and bolts in sets to preserve balance.

## **■ OPERATION**

- Do not operate the engine in a confined space where dangerous carbon monoxide fumes can collect.
- Mow only in daylight or in good artificial light.



- Avoid operating the equipment in wet grass, where feasible.
- Always be sure of your footing on slopes.
- Walk, never run.
- For wheeled rotary machines, mow cross the face of slopes, never up and down.
- Exercise extreme caution when changing direction on slopes.
- Do not mow excessively steep slopes.
- Use extreme caution when reversing or pulling the lawnmower towards you.
- Stop the blade if the lawnmower has to be tilted for transportation when crossing surfaces other than grass, and when transporting the lawnmower to and from the area to be mowed.
- Never operate the lawnmower with defective guards, or without safety devices, for example deflectors and/or grass catchers, in place.
- Do not change the engine governor settings or overspeed the engine. Operating the engine at excessive speed may increase the hazard of personal injury.
- Start the engine carefully according to instructions and with feet well away from the blade.
- Do not tilt the lawnmower when starting the engine, except if the lawnmower has to be tilted for starting. In this case, do not tilt more than absolutely necessary and lift only the part which is away from the operator.
- Do not start the engine when standing in front of the discharge chute.
- Do not put hands or feet near or under rotating parts.
- Keep clear of the discharge opening at all times.
- Never pick up or carry lawnmower while the engine is running.
- Stop the engine and disconnect the spark plug wire:
  - before cleaning blockages or unclogging chute;
  - before checking, cleaning or working on the lawnmower;
  - after striking a foreign object. Inspect the lawnmower for damage and make repairs before restarting and operating the lawnmower;
  - if the lawnmower starts to vibrate abnormally (check immediately).









- Stop the engine:
- whenever you leave the lawnmower;
- before refueling.
- Reduce the throttle setting during engine shut down and, if the engine is provided with a shut off valve, turn the fuel off at the conclusion of mowing.

## MAINTENANCE AND STORAGE

- Keep all nuts, bolts and screws tight to be sure the equipment is in safe working condition.
- Never store the equipment with petrol in the tank inside a building where fumes may reach an open flame or spark.
- Allow the engine to cool before storing in any enclosure.
- To reduce the fire hazard, keep the engine, silencer, battery compartment and petrol storage area free of grass, leaves, or excessive grease.
- Check the grass catcher frequently for wear or deterioration.
- Replace worn or damaged parts for safety.
- If the fuel tank has to be drained, this should be done outdoors.

## THESE SYMBOLS MAY APPEAR ON YOUR MACHINE OR IN THE LITERATURE SUPPLIED WITH THE PRODUCT. LEARN AND UNDERSTAND THEIR MEANING.

<p><b>⚠ WARNING!</b> A equipment is a dangerous tool if used carelessly or incorrectly and can cause serious, even fatal injuries. It is extremely important that you read and understand the contents of this Operator's Manual. Please read the operator's manual carefully and make sure you understand the instructions before using the machine.</p>	
<p>Danger of thrown objects Keep other people at a safe distance while working</p>	

Always wear protective equipment	
Switch off the device and disconnect the spark plug before carrying out any maintenance, cleaning or transport work on it	
Guaranteed sound power level	
Please read the Instruction manual carefully and make sure you understand the instructions before using the machine.	
Danger of cutting yourself Blades in movement. Do not put hands or feet near or under the opening of the cutting plate.	
Device is powered by gasoline and fuel. Be especially careful when operating or moving the device.	
No open flames, no inhalation of toxic gases	
This product is in accordance with applicable CE directives	

## ■ ASSEMBLING

1- Lower handle assembling.

- Insert pin into the round hole of lower handle from both left and right side.
- Insert square neck bolt (M8×20) into the bracket and lower handle, then tighten with knob nut.

**⚠ NOTE:** The handle level (high, medium or low) can be adjusted by setting of square neck bolt in one of the three holes on the bracket.



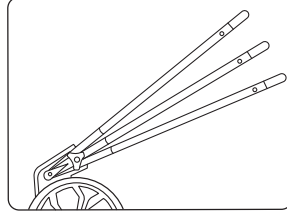
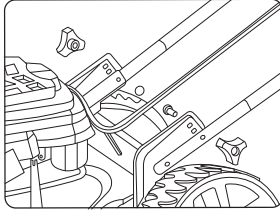

## 2- Upper handle assembling

- Insert bolt (M8X45) into left handle holder, lower handle and upper handle assembly in turn, then tighten with knob nut.
- Insert bolt (M8X45) into right handle holder, lower handle, upper handle assembly and start rope hook in turn, then tighten with knob nut.
- Fasten cables with the clips on the handle rod.

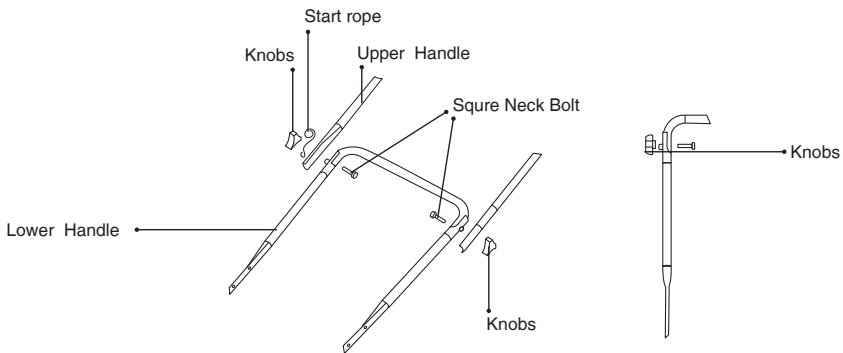

## 3- Grass catcher assembling

- Hold up the rear cover and fit the grass catcher.

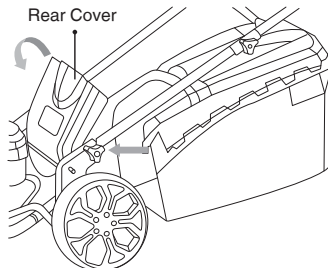

#### 4- Grass collection setting:

##### 1- For rear bagging

- Grass catcher box installed.

##### 2- For rear discharging

- stall grass catcher.
- close the rear cover.

##### 3- For side discharging(If equipped)

- Rear cover closed.
- keep pushing down the "PUSH", then open the side cover
- side discharge guard installed.

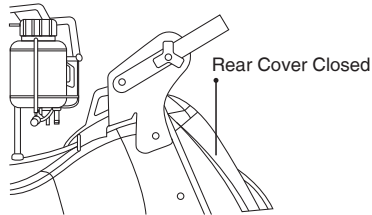

#### 4- For mulching

- Lift the rear cover and hold up, insert mulching.
- Rear cover closed

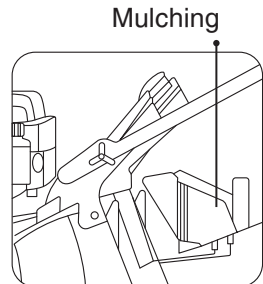
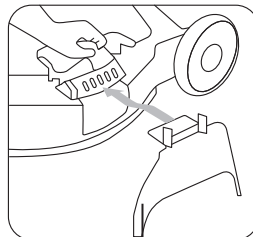
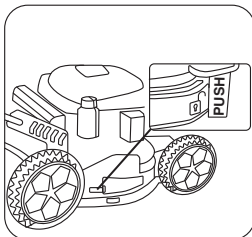

#### 5- Working depth setting

Only when mower is stationary and rotating blade has come to complete standstill.

Mow the lawn twice weekly during the most active periods of growth. Never cut more than 1/3 of the length of the grass, especially during dry periods. Mow with a high cutting height setting the first time. Examine the result and lower the mower to the desired setting. Mow slowly or mow the grass twice if it is very long.

1=30mm 2=40mm 3=50mm 4=60mm 5=70mm 6=80mm

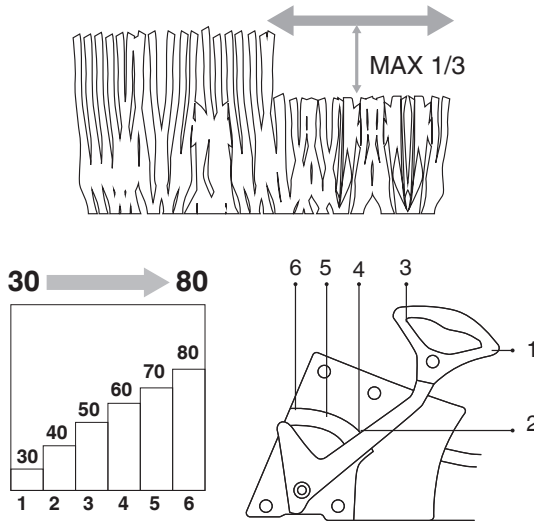

## ■ START AND STOP

1- Add fuel: Add fuel only when the engine is cold.

- Place the lawnmower level.
- Clean around the filter cap
- Remove the filter cap
- Using a clean funnel, fill tank to approximately 5mm below the inner edge of the filter neck, being careful not to spill fuel.
- Tighten the filter cap back and clean any spilled fuel.

**⚠ NOTE:** not on gravel or similar. Fill the tank with petrol, not oilblended. Lead free petrol may be used.

**DO NOT FILL WITH PETROL WHILE THE ENGINE IS RUNNING.**

2- Add oil: See the Technical data table for the oil to be used.

- Place engine level.
- Clean around oil fill.
- Remove the filter cap, clean the tip of the dipstick, insert and tighten down.
- Remove dipstick again and check the oil level that must be between the “MIN” and “MAX” marks.
- If oil is required, add oil of the same kind up to the “MAX” mark, being careful not to spill any outside the oil fill.
- Close the filter cap and wipe off any spilled oil.

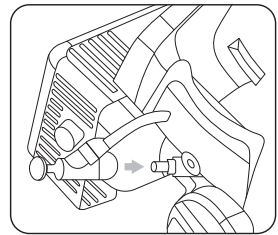
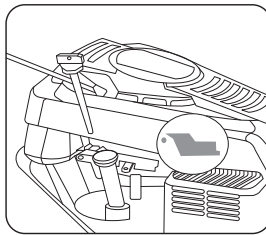
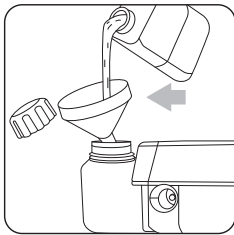
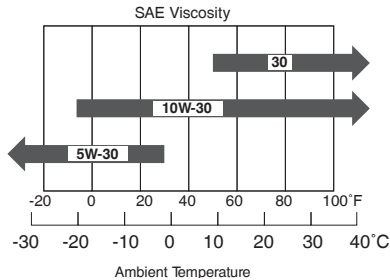

**3- Spark plug cap**

Connect the cap of cable to the spark plug, making sure that there is no grass or dirt either inside the cap or on the spark plug terminal.

**4- Starting engine:**

Always start the engine with the lawnmower traction device (if equipped) disengaged.

- a- Push down the button three times.
- b- Close blade control handle, as shown in the lawnmower instructions.

- c- Then pull cord rapidly.
- d- When engine starts, release the recoil starter.

**! NOTE:** If the engine does not start, repeat whole starting procedure.

**! NOTE:** If the engine starts but does not keep running, repeat the whole.

## STARTING

### **.STARTING THE ENGINE (HOT STARTING)**

Follow the whole cold starting procedure.

### **! WARNING!**

Keep your hands away from the silencer and surrounding areas that can become extremely hot. With the engine running, do not get loose fitting clothing (ties, scarves, etc.) or hair closer to the top part of the engine.

#### 5- Drive

- Forward drive is engaged and disengaged with the drive control at the top of the handle.

#### 6- Stopping during operation

Release the blade control handle to stop the engine.

#### 7- Stopping at the end of operation

a- Release the blade control handle to stop the engine.

b- Once the engine has cooled, disconnect the spark plug cap.

c- Remove any grass build up from the engine, in particular from the silencer, to reduce fire hazard.

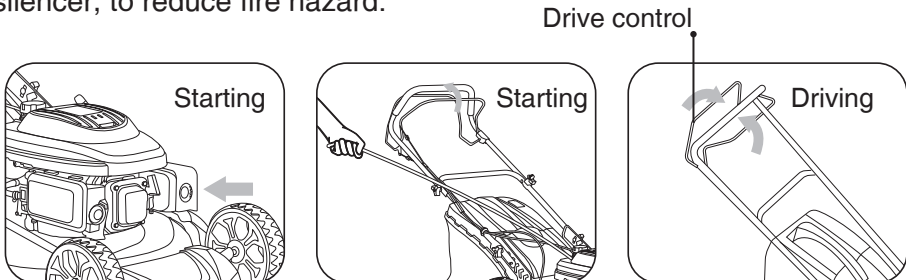

## ■ OPERATION

1- The mower should not be used on ground that slopes more than 15°. This could cause engine lubrication problems.

2- To empty grass catcher: when the indicator cap is closed, the grass catcher is full. Please empty it.

- To remove grass box, release engine brake control to stop engine.
- Lift up rear cover and remove the grass catcher by the handle.
- Empty the grass catcher.

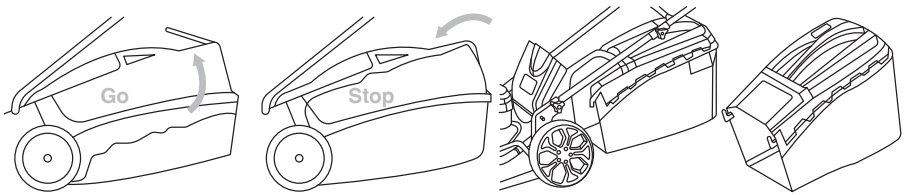

- Do not drag the bag when emptying, it will cause unnecessary wear.

## ■ MAINTENANCE AND STORAGE

Always remove the spark plug lead before repair, cleaning or maintenance work. After 5 hours running time, tighten screws and nuts. Check the oil.

Clean mower thoroughly after each mowing with cloth or brush.

Do not spray with water. Keep mower in a dry room.

- Annually (After end of season)

Grinding and balancing the cutter blade. Remove the sparkplug lead.

Fitting and removing the blade require the use of protective gloves.

Tighten the screw properly when reassembling.

Drain fuel from tank to prevent buildups inside the tank. Change oil after each season or after 25 hours running time. Run the engine warm, remove the spark plug lead.

Remove the drain plug from bottom of engine and drain oil. Fill with new oil.

## ■ CLEANING OF AIR FILTER

Keep the filter clean and oil saturated. Replace it if broken, cut or with damaged parts.

### **! IMPORTANT!**

Never use compressed air to clean the filtering element.

- Clean around the filter cover
- Release the clip; remove the cover and the foam element.
- Wash the foam element in liquid detergent and water. Squeeze dry in a clean cloth.
- Saturate the foam element with 2 table spoons of clean engine oil and squeeze it a few times to distribute the oil evenly.
- Remove excess oil with a clean cloth.
- Clean the interior of the air cleaner housing from any dust and grass, making sure that they do not enter the intake manifold.
- Install the foam element in its housing and close the cover.

If the foam element has been replaced, proceed to oil the new filter as described above in sections.

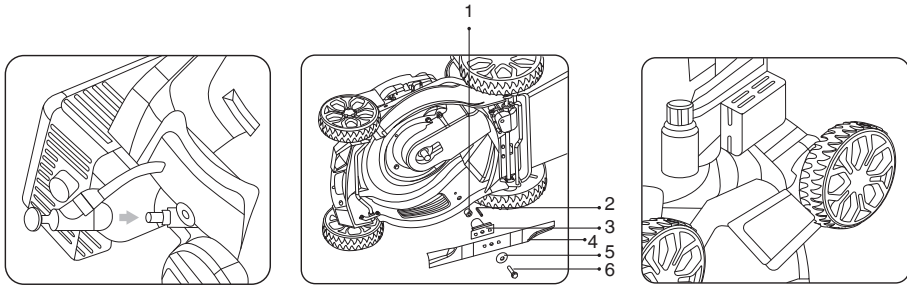

## TROUBLESHOOTING

PROBLEM	LIKELY CAUSE	SOLUTION
Hard starting	No fuel	Check and top up
	Stale fuel or build-ups in tank	Empty fuel tank and refill with fresh fuel
	Spark plug disconnected	Check that the spark plug cap fits well over the plug terminals
	Dirty electrodes or incorrect gap	Check
	Air filter clogged	Check and clean the air cleaner
	Incorrect oil for the season	Replace with proper oil
	Fuel evaporation in the carburetor (vapor lock) due to high temperatures	Wait for a few minutes then start again
	Fault in carburation	Contact a Licensed Service Center
Inconsistent working	Stale fuel or build-ups in tank	Empty fuel tank and refill with fresh fuel
	Dirty electrodes or incorrect gap	Check
	Air filter clogged	Check and clean the air cleaner
	Fault in carburation	Contact a Licensed Service Center
Loss of power while mowing	Air filter clogged	Check and clean the air cleaner
	Fault in carburation	Contact a Licensed Service Center
	Governor out of phase with respect to the accelerator	Adjust the cable





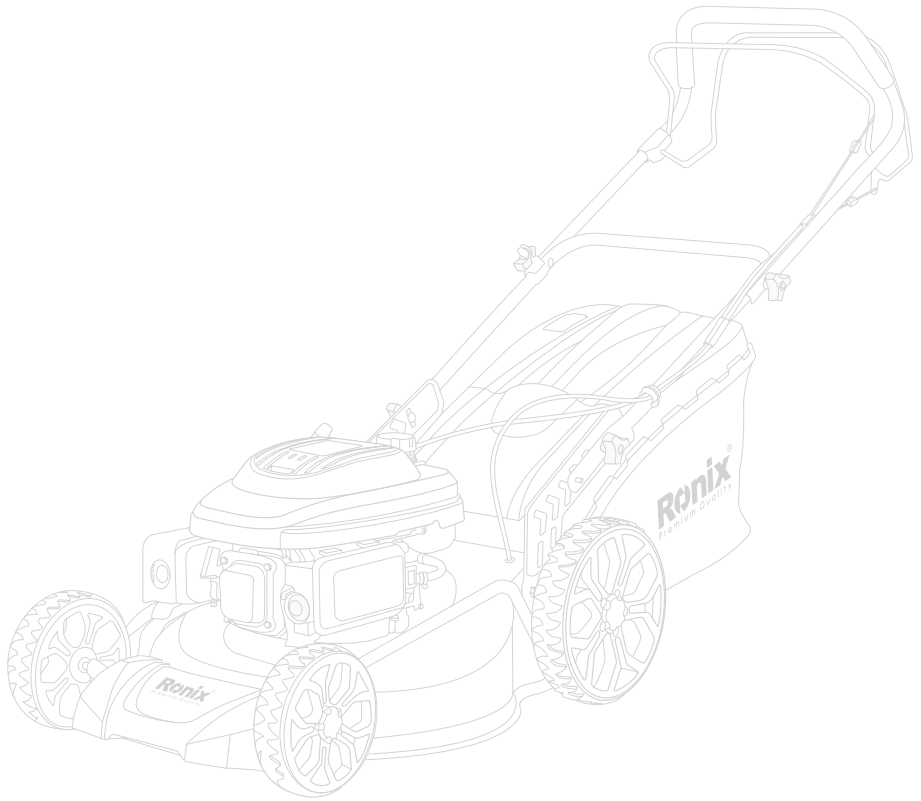

# GASOLINE LAWN MOWER





[www.ronixtools.com](http://www.ronixtools.com)